

Site Access and Occupation.

The successful tenderer will:

1. Upon award and before establishing on site be introduced to Craig Davis, City of Canada Bay's Co-ordinator Parks & Sports Fields.
2. Consult with Craig and provide a site management plan for approval.
3. Negotiate all changes of site access and perimeter with Craig.

Please note that the sports field perimeter is soft after spells of wet weather.

Any damage to the sports field will need to be restored to the satisfaction of Craig Davis who will provide a list of endorsed sports field restoration contractors.

Occupation of the perimeter of the sports field to undertake the drainage works and to provide construction access to the front of the building will need to be negotiated with the users of the sports field. Please note that the cricket season commences at the end of September and preparation for the cricket season begins at the end of August.

An additional suggestion for access to the construction site is provided in the attached PDFs. These are provided as guides only. Please note that the site specific management plan is to be reviewed and approved by City of Canada Bay.

An application has been made for the approval of a kerbside work zone extending from the bus zone south of the site to the street light pole at the north of the site. Note that the kerb side lane is in excess of 5m wide.

Keys to the adjacent public toilets can be provided to the successful tenderer for use by site staff.

DATE PLOTTED: 18 March 2016 5:40 PM BY: ALEX CUTILLI

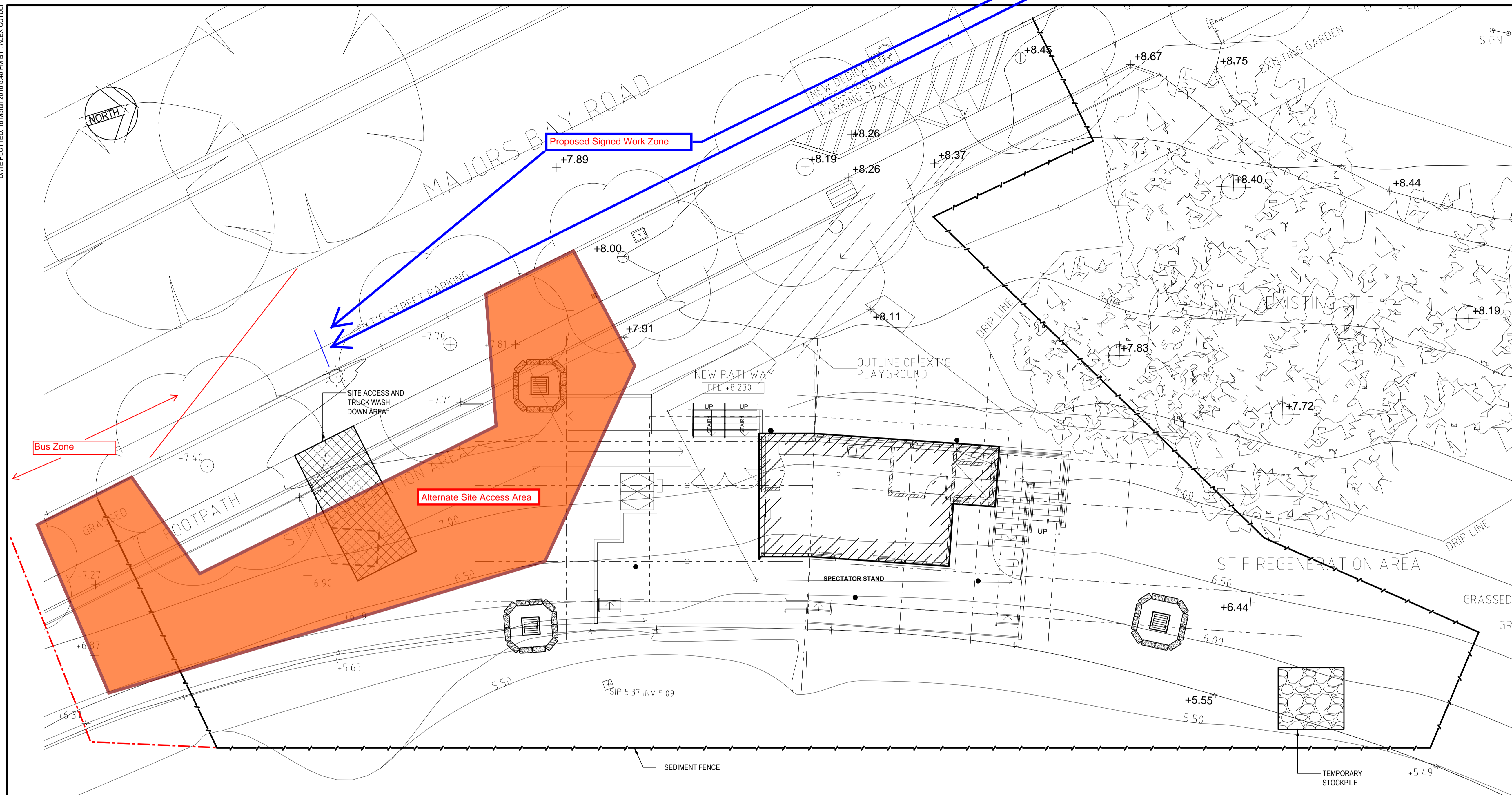

LEGEND

- PROPOSED STORMWATER PIT
- PROPOSED STORMWATER PIPES
- PROPOSED KERB ONLY
- PROPOSED SAWN JOINT
- PROPOSED EXPANSION JOINT
- PROPOSED SLAB THICKNESS
- PROPOSED AREA OF NEW CONCRETE PAVEMENT
- PROPOSED SUB SOIL DRAIN
- PROPOSED HIGH POINT
- PROPOSED CLEAN OUT
- GRATED DRAIN
- SILT FENCE/HAYBALE
- SILT TRAP/SAND BAGS

NOTE:
THIS LAYOUT PRESENTS ONE OF A NUMBER OF POSSIBLE SOLUTIONS FOR THE EROSION AND SEDIMENTATION CONTROL ON THE SITE DURING THE CONSTRUCTION PERIOD. FINAL LAYOUT TO BE PREPARED BY THE CONTRACTOR TO SUIT THEIR SITE LAYOUT, OPERATIONS SEQUENCE, STAGING ETC. ALL CONTROLS TO BE CONSTRUCTED ACCORDING TO THE REQUIREMENTS OF "MANAGING URBAN STORMWATER SOILS AND CONSTRUCTION" - 4TH EDITION LANDCOM, MARCH 2004.

NOTE:
SITE ACCESS AND STOCKPILE LOCATION MAY CHANGE DEPENDING ON CONSTRUCTION PREFERENCE

SEDIMENT AND EROSION CONTROL PLAN

SCALE 1:100

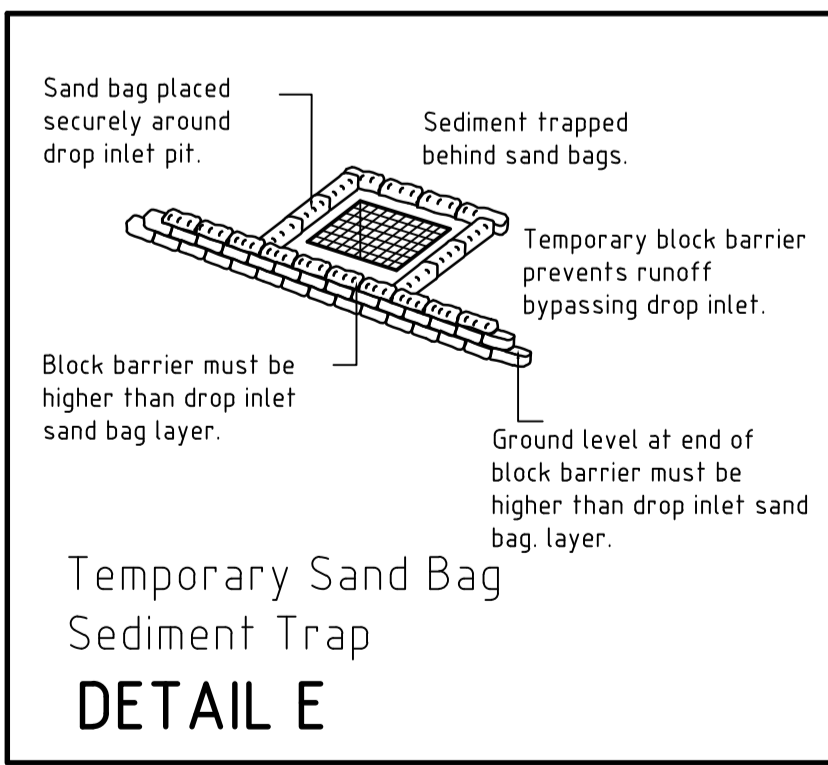
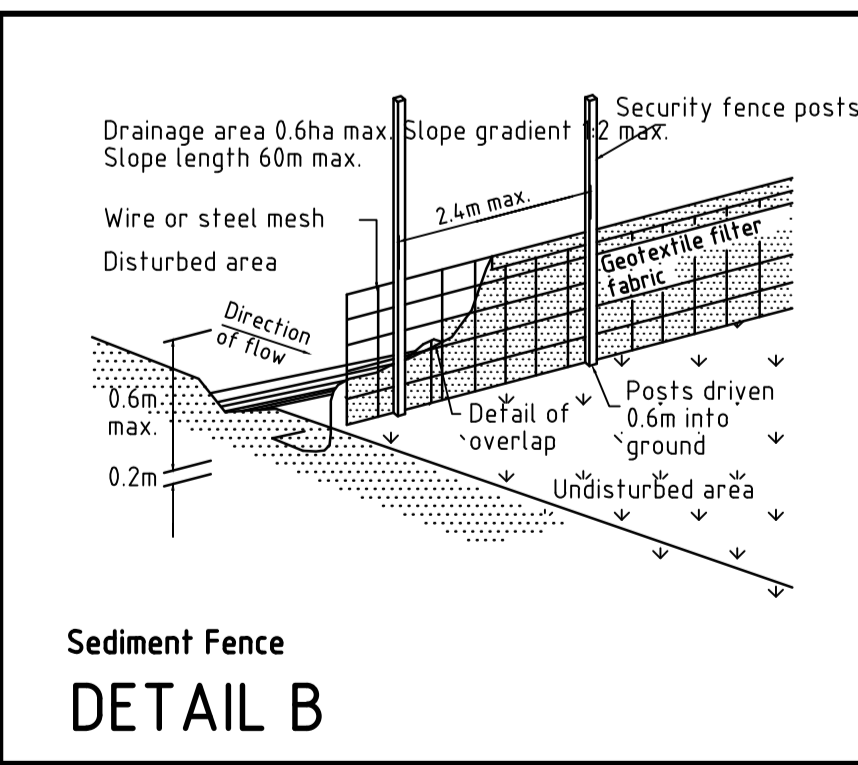
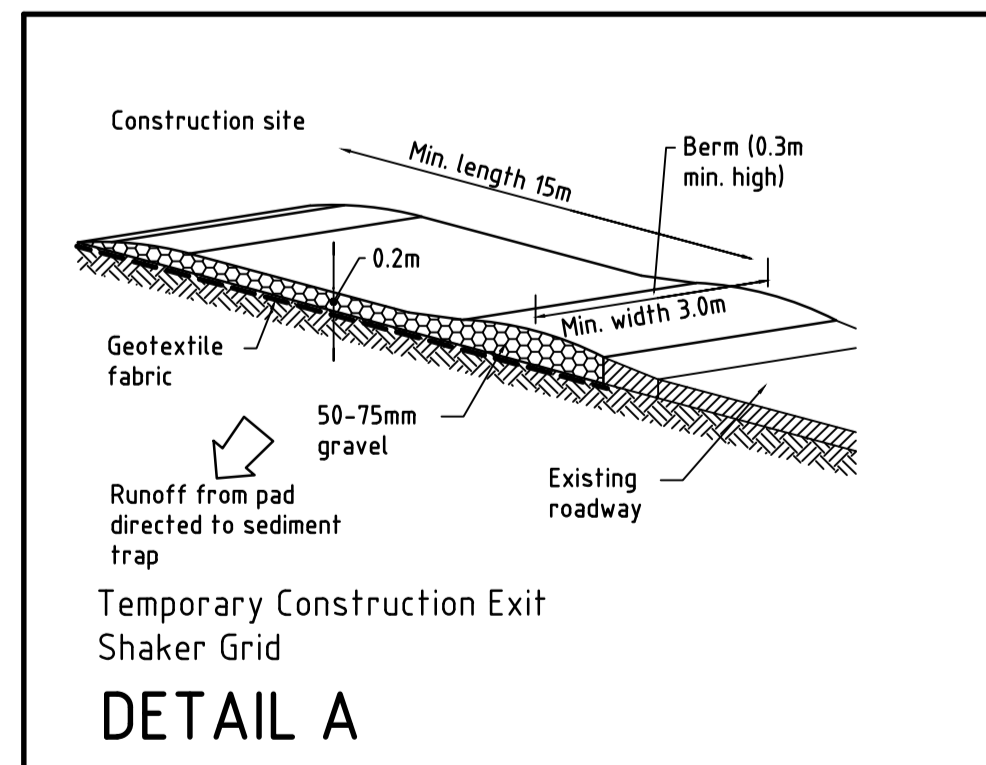

SEDIMENT RUN-OFF CONTROL NOTES

SR1. THE CONTRACTOR SHALL INSTALL AND MAINTAIN SOIL EROSION AND SEDIMENT CONTROL MEASURES GENERALLY IN ACCORDANCE WITH GUIDELINES OF THE LANDCOM MANAGING URBAN STORMWATER MANUAL AND AS NECESSARY TO PREVENT RUN-OFF FROM SITE OF SEDIMENT RESULTING FROM THE WORKS. SUCH MEASURES SHALL ALSO COMPLY WITH REQUIREMENTS OF COUNCIL AND EPA. THIS WORK SHALL BE DONE PRIOR TO ANY EARTHWORKS COMMENCING ON SITE.

SR2. GRADE FINISHED SURFACE TO SHED WATER EVENLY WITHOUT CHANNELLING (UNTIL PIPED STORMWATER SYSTEM IS CONSTRUCTED). NOMINAL GRADIENTS FROM HIGH POINT OF 0.2%.

SR3. MAINTAIN THE EROSION CONTROL DEVICES INDICATED ON THE DRAWINGS TO THE SATISFACTION OF THE SITE SUPERINTENDENT AND THE LOCAL AUTHORITIES.

SR4. WHEN PROPOSED STORMWATER PITS ARE CONSTRUCTED, PREVENT SITE RUNOFF ENTERING UNLESS SILT FENCES ARE ERECTED AROUND PITS AND ON ROAD.

SR5. STREET PROTECTION WITH SHAKER EXIT GRIDS & STREET PIT INLET PROTECTION TO BE MAINTAINED FOR THE DURATION OF THE CONTRACT.

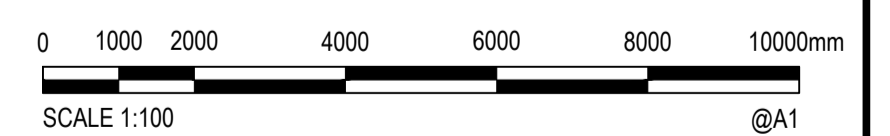
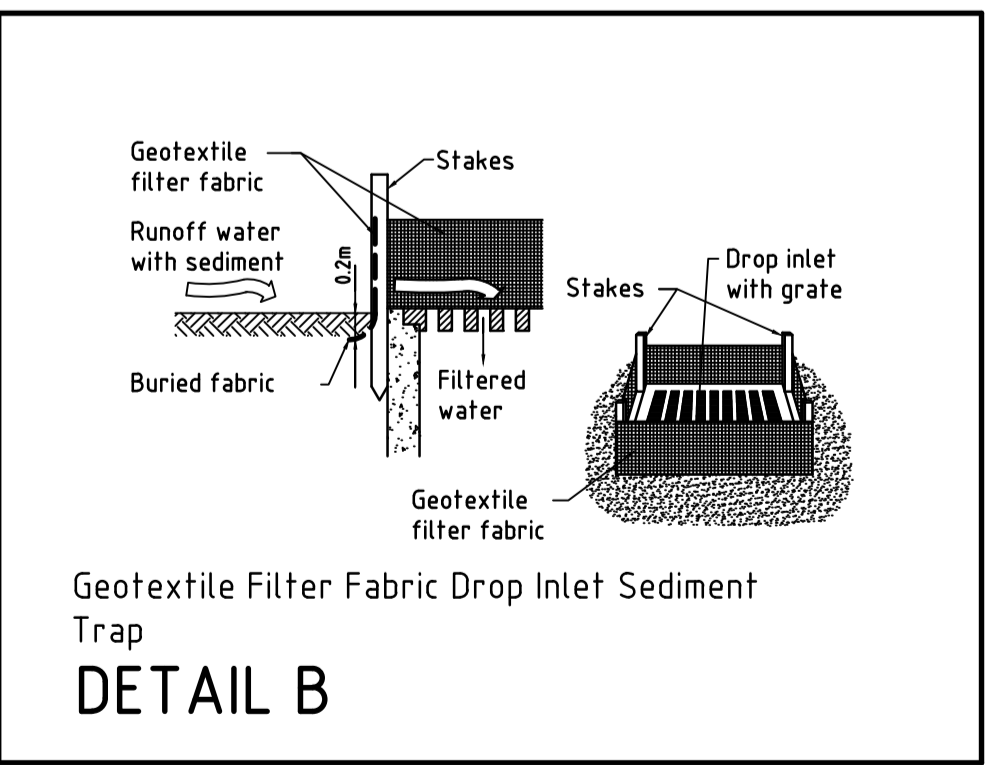

Rev.	Date	Description	Des.	Verif.	Appd.
4	18/03/2016	REVISED CC ISSUE	AC	TY	TY
3	16/03/2016	CC ISSUE	AC	TY	TY
2	26/10/2015	TENDER ISSUE	LPD	TY	TY
1	21/09/2015	CONSTRUCTION CERTIFICATE ISSUE	LPD	TY	TY

© Cardno Limited All Rights Reserved.
This document is produced by Cardno Limited solely for the benefit of and use by the client in accordance with the terms of the retainer. Cardno Limited does not and shall not assume any responsibility or liability whatsoever to any third party arising out of any use or reliance by third party on the content of this document.

Cardno (NSWACT) Pty Ltd | ABN 95 001 145 035
Level 9, The Forum, 203 Pacific Highway
St Leonards, NSW 2005
Tel: 02 9496 7700 Fax: 02 9439 5170
Web: www.cardno.com.au

Drawn	LPD	Date	SEP. 2015
Checked	TY	Date	
Designed	TY	Date	
Verified	TY	Date	
Approved		Date	

Client	BRIARS SPORTING CLUB
Project	COMMUNITY AND AMENITIES BUILDING ROTHWELL PARK CONCORD
Title	SEDIMENT AND EROSION CONTROL PLAN AND DETAILS

Status	FOR APPROVAL		
	NOT TO BE USED FOR CONSTRUCTION PURPOSES		
Scale	1:100	Size	A1
Drawing Number	80816048-CI-0003	Revision	4

XREFs: xsite_xpnd_80816048-CI-0002_80816048-CI-0001
CAD File: N:\Projects\80816048_Community_Facility\Drawings\Build\80816048-CI-0003.dwg

